

(PLEASE TYPE OR PRINT – INK ONLY)

APPLICATION FOR A LARGE DAY CARE HOME
ORANGE COUNTY

Date: _____

The Orange County Zoning Ordinance defines a Large Day Care Home as a day care facility located on a public state maintained road, which provides day care for more than five (5) but fewer than sixteen (16) children, within a residence.

NAME OF APPLICANT: _____

ADDRESS: _____

TELEPHONE: _____

PROPERTY OWNER (IF DIFFERENT): _____

ADDRESS: _____

TELEPHONE: _____

LOCATION: _____

A SUMMARY INFORMATION

ORANGE COUNTY TAX MAP _____ BLOCK _____ LOT _____ TWP _____

ZONING DISTRICT(S): _____

LOT ACREAGE: _____

SQUARE FOOTAGE USED FOR LARGE DAY CARE HOME: _____

SQUARE FOOTAGE USED FOR OUTDOOR PLAY SPACE: _____

ACCESSORY BUILDING _____ YES _____ NO

NUMBER OF EMPLOYEES (INCLUDING BUSINESS OWNER): _____

NUMBER OF CHILDREN PROPOSED: _____

SIGNAGE: _____ YES _____ NO SIZE OF SIGN: _____

DESCRIPTION AND OPERATIONAL CHARACTERISTICS OF LARGE DAY CARE HOME:

B OTHER SUBMITTAL REQUIREMENTS

- 1) Evidence that the minimum requirements to qualify for a State of North Carolina large day care home license are satisfied.
- 2) A floor plan of the proposed large day care home, showing the use and dimensions of each room and the location of entrances and exits.
- 3) Indicate how the large day care home is located in an area which is free from conditions dangerous to the physical and moral welfare of the children.
- 4) There must be direct frontage and access on a public state maintained road.
- 5) Indicate how there is adequate access to and from the site as well as adequate space off the road right-of-way for the safe pick-up and discharge of children. This space shall be provided in such a manner that traffic generated by the large day care home is not disruptive to adjacent residentially developed properties.
- 6) The site plan shall show how the facilities will be screened from adjacent properties. A Type A 30-foot buffer shall be provided around the large day care home play area. These buffers will effectively screen the view of any outdoor play area, and reduce noise associated with the day care.
- 7) Each large day care home is required to provide at least 75 square feet of outdoor play space for every child in care. This space may not be located in a required buffer or in an area which is used or reserved for use as a sewage disposal nitrification field.

Fencing is to be provided around the outdoor space which assures the protection of the children receiving day care and protects adjacent residentially developed properties from trespass.

- 8) The site plan shall show the location of the residence in which the large day care home is to be located in relation to existing property lines and adjacent homes; the location, number, and means of access to required off-street parking areas; and the location and type of required landscaping and/or screening.

C CERTIFICATION (Office Use Only)

- _____ Minimum state requirements are met for a large day care home license.
- _____ Floor plan of proposed large day care home.
- _____ Large day care home is located in area away from conditions dangerous to physical and moral welfare of the children.
- _____ There is direct frontage on a public state maintained road.
- _____ There is adequate access and space for pickup and discharge of children.
- _____ The area is not disruptive to adjacent residentially developed properties.
- _____ Site plan shows adequate screening.
- _____ There is atleast 75 square feet of outdoor play space for every child in care. This area is not in a buffer or sewage disposal nitrification field.
- _____ Fencing is provided around the outdoor space.
- _____ Site plan meets Zoning Ordinance requirements (specified in B.8 above).
- _____ Signage (if proposed) meets Zoning Ordinance.
- _____ Additional conditions (if required).

I, the applicant, hereby certify that the foregoing application is complete and accurate. I understand that I am bound to comply at all times with the rules and regulations for large day care homes as specified in the Orange County Zoning Ordinance.

APPLICANT'S SIGNATURE

OWNER'S SIGNATURE

DATE

DATE

(OFFICE USE ONLY)

LARGE DAY CARE HOME REQUEST: _____ APPROVED _____ DENIED

Additional Conditions of Approval (if required): _____

Specify reason(s) for denial: _____

DATE: _____ STAFF PERSON: _____

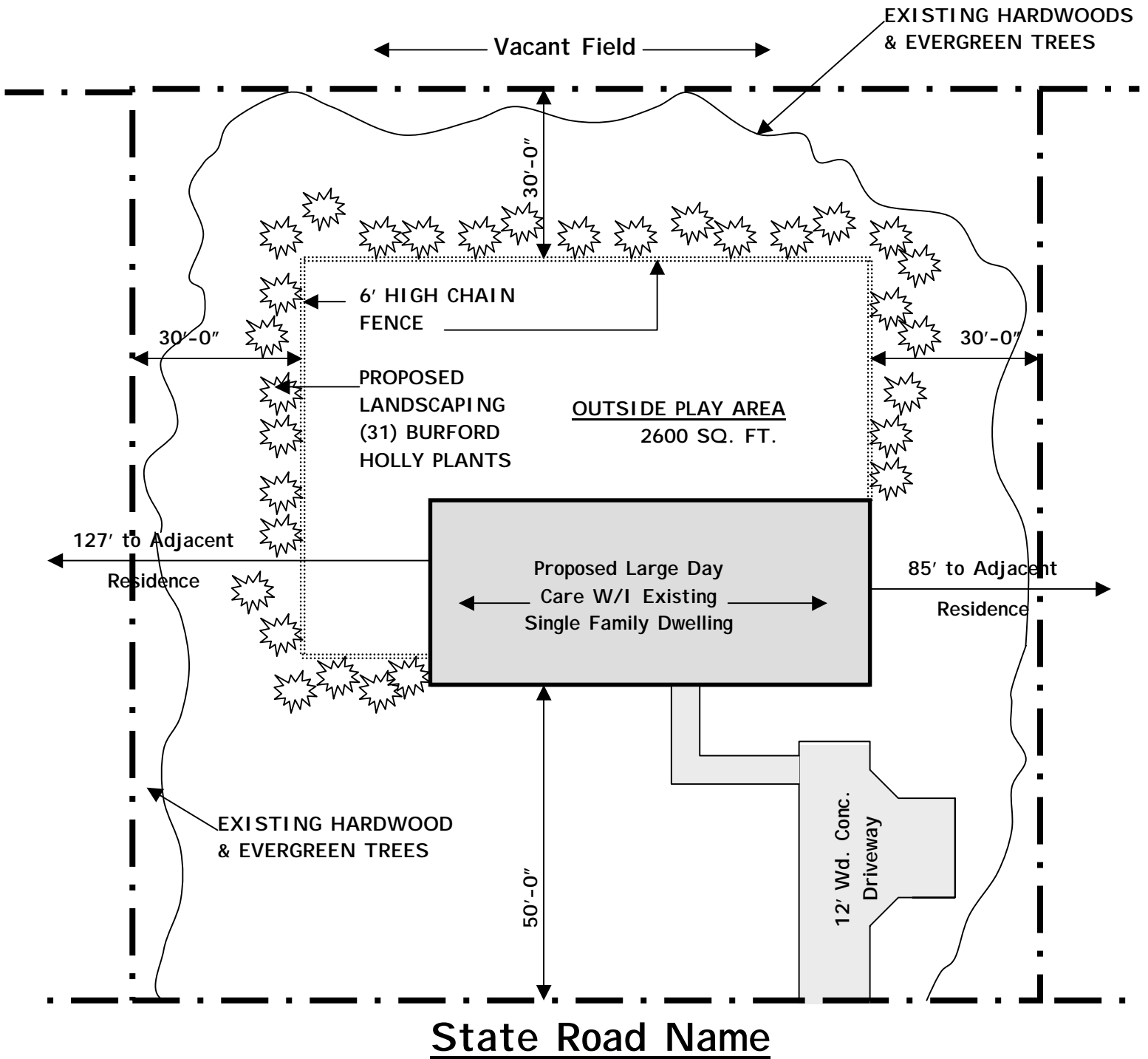

Site Plan to include the following information:

1. Type A 30' buffer around play area
2. Outdoor play space
3. Septic tank location (if applicable)
4. Location of residence in reference to property lines and adjacent homes
5. Location, number and means of access to required off-street parking areas
6. Location and type of any required landscaping or screening

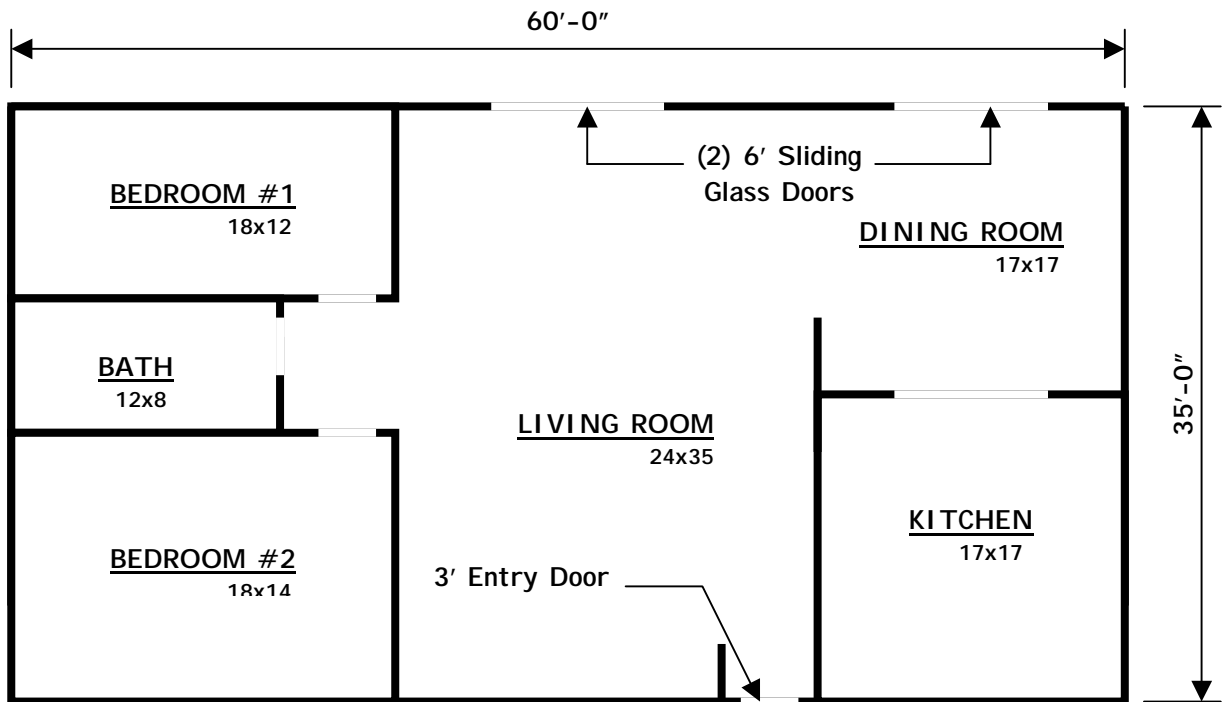

SAMPLE FLOOR PLAN

The following items must be on your floor plan:

1. The use and dimensions of each room
2. Clearly marked access doors to outside.